

EXISTING CONDITIONS PLAN

CAMBRIDGE SHIPYARD FACILITY
 101 HAYWARD STREET
 DORCHESTER COUNTY, MARYLAND 21613

DATE:
 07/20/2020

SCALE:
 1" = 100'

SK-6

SHEET 06 OF 26

© WBCM 2020

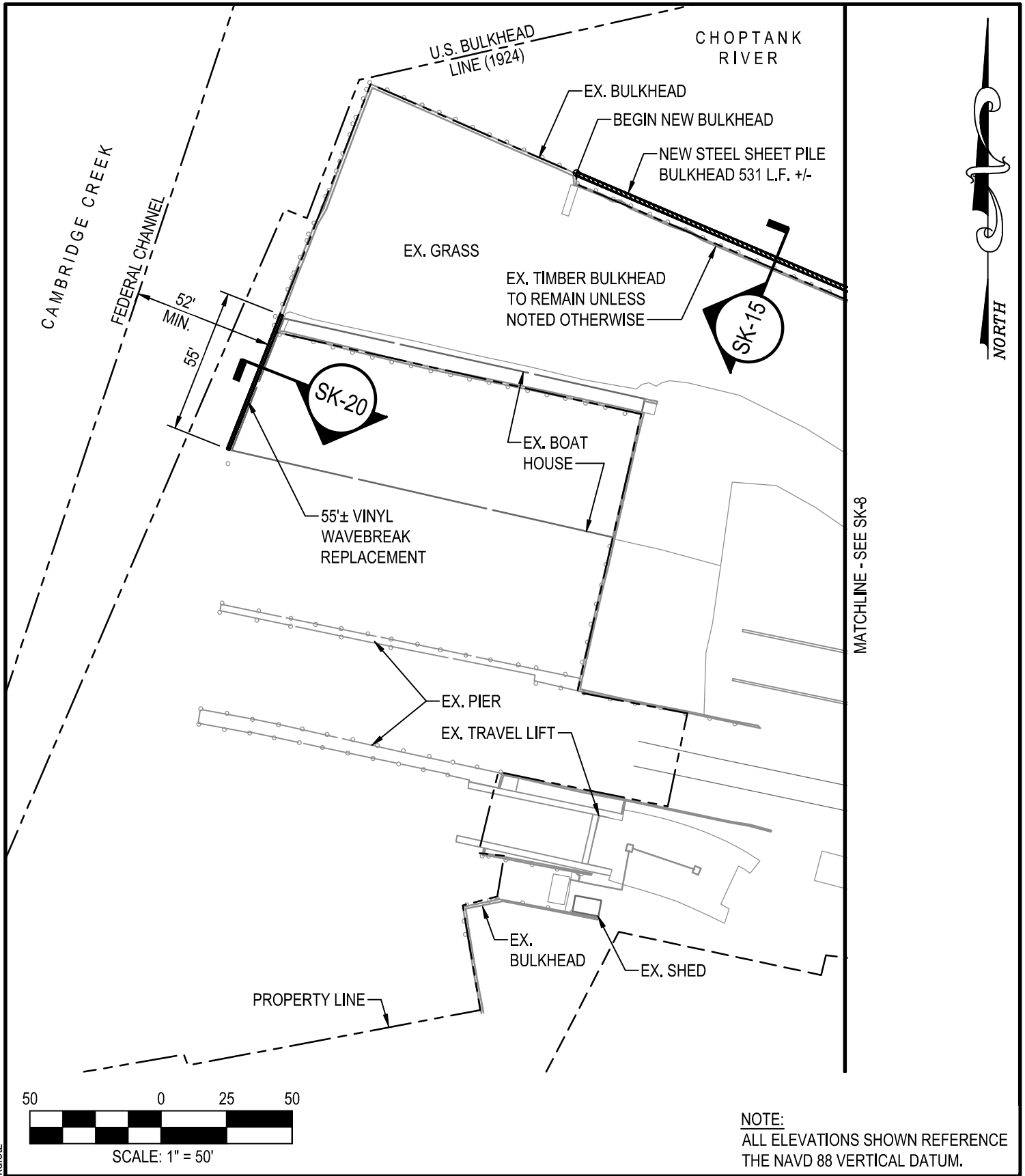

Aug 17, 2020 - 11:11am User: kdietz



WBCMC
Designing Infrastructure for Tomorrow®

WHITNEY BAILEY COX & MAGNANI, LLC
 300 East Joppa Road Suite 200
 Baltimore, MD 21286
 410.512.4500 www.wbcm.com

PROPOSED IMPROVEMENTS (1 of 2)

CAMBRIDGE SHIPYARD FACILITY
 101 HAYWARD STREET
 DORCHESTER COUNTY, MARYLAND 21613

DATE:
07/20/2020

SCALE:
1" = 50'

SK-7
 SHEET 07 OF 26
 © WBCM 2020

